

Thermostatic Valves

PUSH PUSH PRESET KV VALVE

D3803S

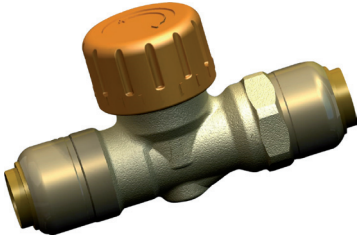

APPLICATION

These thermostatic valves are suitable for all COMAP thermostatic heads as well as for the Electro-thermal heads from Möhlenhoff with VA80 adaptor.

They work as permanent proportional regulators. Together with the head, they react to temperature variations of the room.

These valves are equipped with a pre-set limitation of the flow. They can be used on two-pipe heating installation with pump.

An orange protective cap easily identifies the model.

EASY TO CONNECT

The push-push connection brings a quick, easy and secure tightness to the copper pipe.

RELIABILITY

COMAP offer high quality thermostatic valves.

CONSTRUCTION

- > **Body** : Hot stamped brass
- > **Insert** : « high resistance » brass
- > **Spring** : stainless steel
- > **Profiled valve with o-ring** : ethylene-propylene ; anti-frost additives
- > **Protective cap** : recycled plastic

D3802S



- > M30x1.5 valves
- > Push-push connection

TECHNICAL DATA

- > Static pressure : PN10
- > Max differential pressure 0.6 bar
- > Max. Temperature : 110°C

Thermostatic Valves

PUSH PUSH PRESET KV VALVE

D3802S 15-15

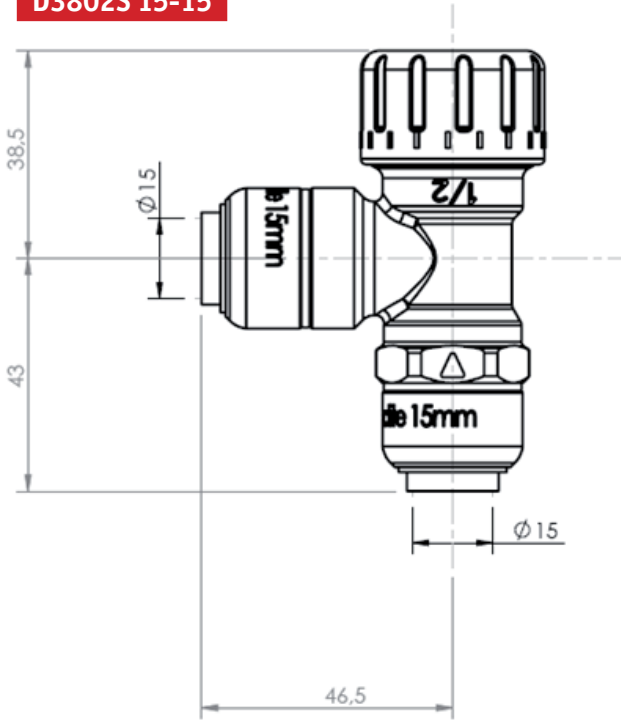

D3803S 15-15

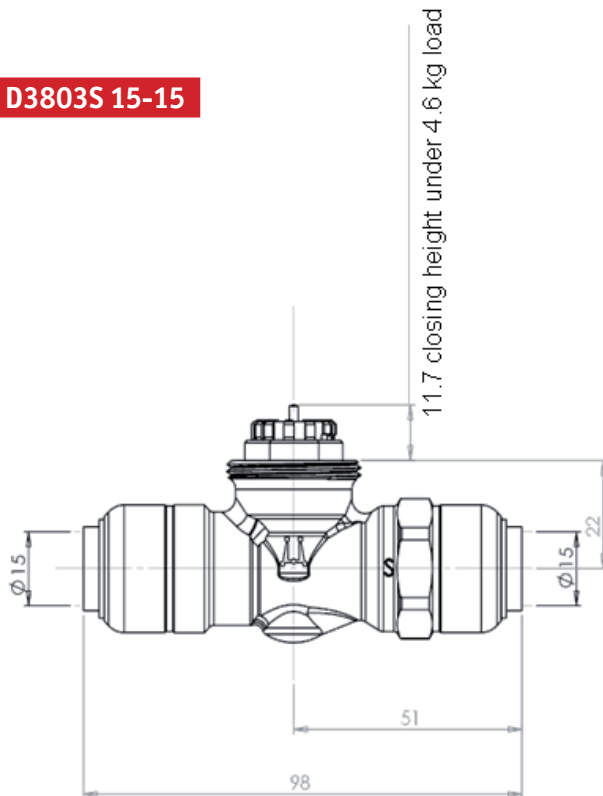

Thermostatic Valves

PUSH PUSH PRESET KV VALVE

D3802S 12-12

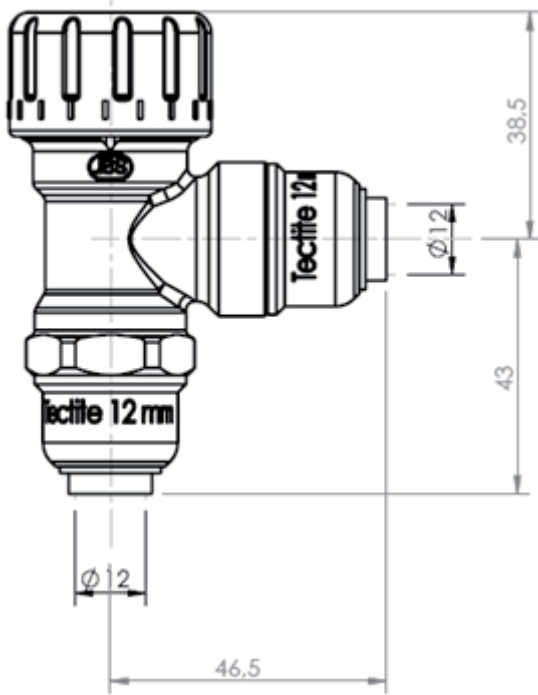

D3803S 12-12

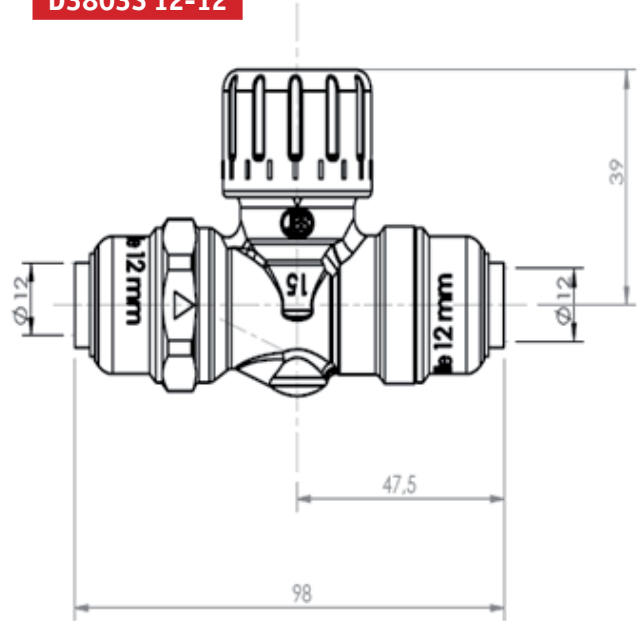

D3802S 10-10

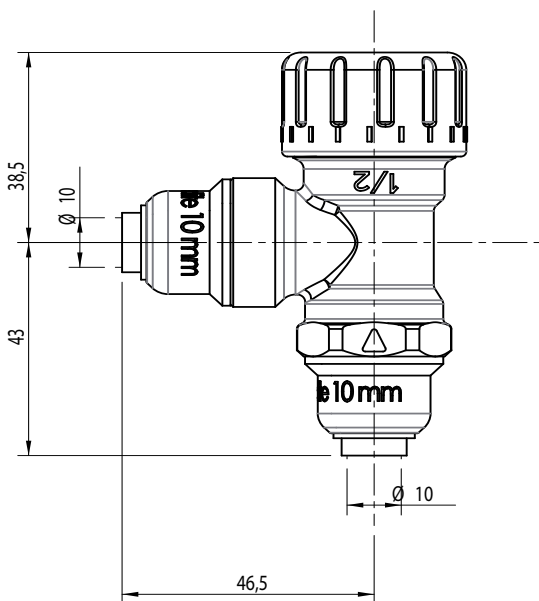

D3803S 10-10

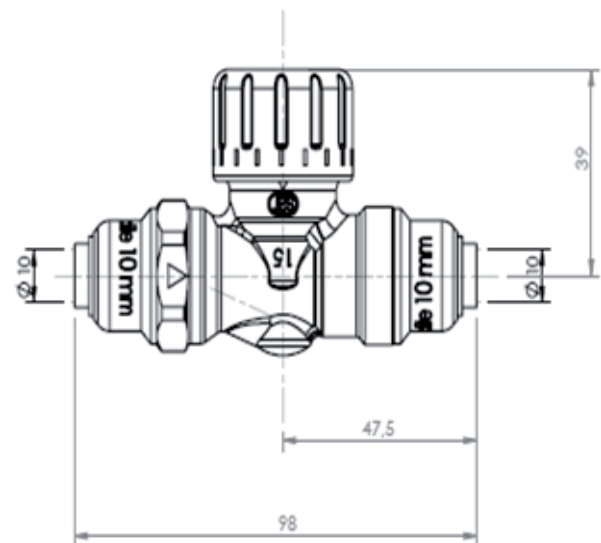

Thermostatic Valves

PUSH PUSH PRESET KV VALVE

D3802S 12-10

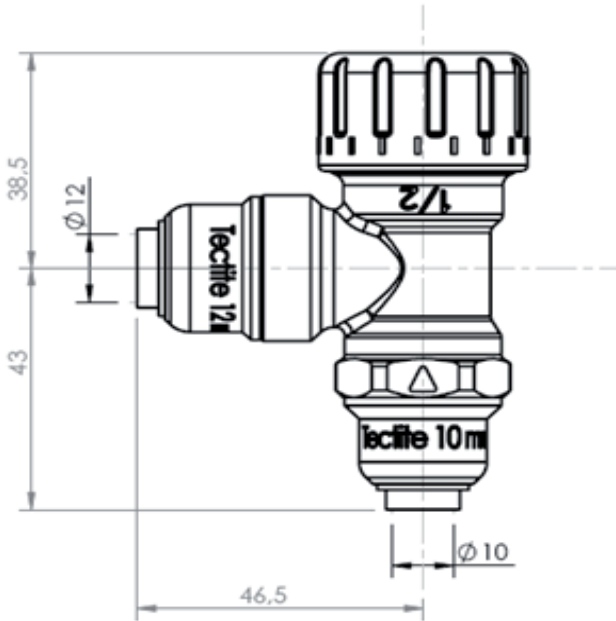

Thermostatic Valves

PUSH PUSH PRESET KV VALVE

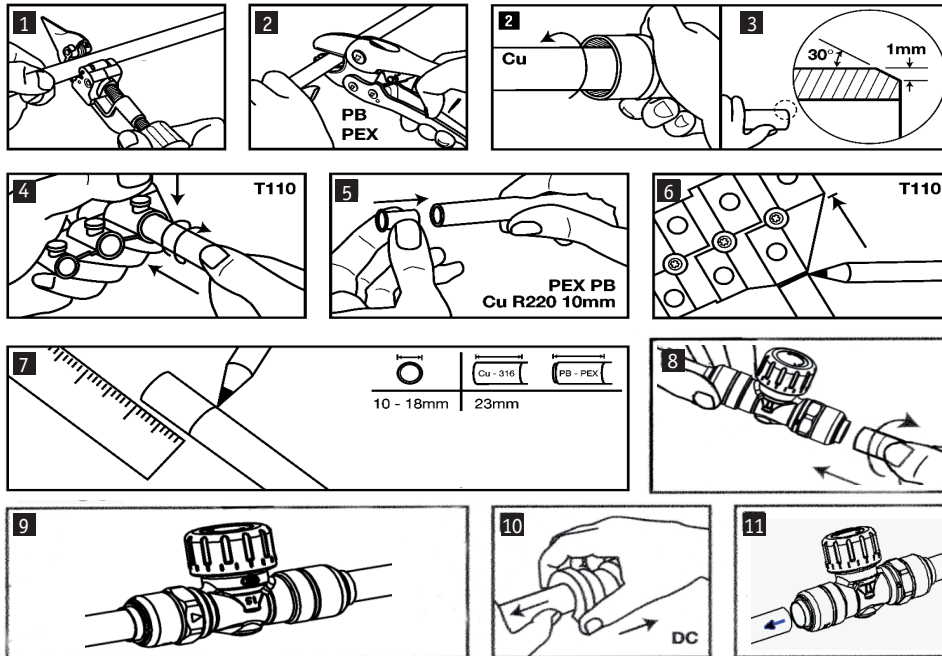

NOMINAL SETTING OF THE VALVE:

- > Close completely the valve by turning the cap to the right until blocked.
- > Pen-mark on the body and the cap the position.
- > Open the valve counting 6 graduations (openings on the cap).

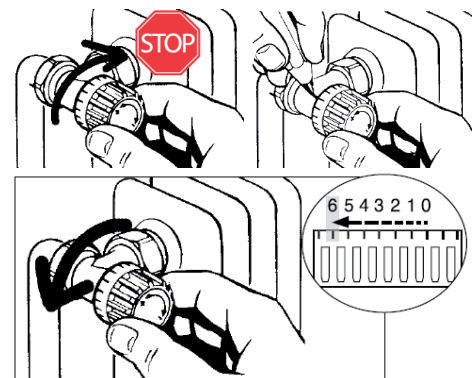

SETTING THE KV VALUE:

- > Use a simple screw-driver to turn the wheel to the desired position.
- > Choose the position and the flow on the below flow chart.

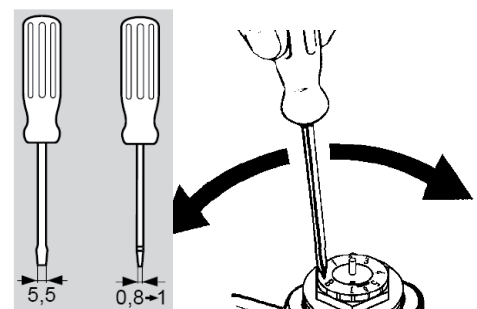

Thermostatic Valves

PUSH PUSH PRESET KV VALVE

SETTING THE KV VALUE - Values are given in L/h

STRAIGHT	D3803S M30 DN15				D3803S M30 DN12 AND DN10	
	POSITION	KV (BP2)	KV (BP3)	KVS	KV (BP3)	KVS
	1	50	50	50	50	50
	2	100	100	100	100	100
	3	170	170	170	170	170
	4	240	240	250	240	250
	5	310	330	350	330	350
	6	380	420	470	420	470
	7	470	540	660	540	660
	8	530	650	820	650	820
	9	610	820	1050	700	900
	10	710	950	1200	820	1000

ANGLE	D3802S M30 DN15				D3802S M30 DN12 and DN10	
	POSITION	KV (BP2)	KV (BP3)	KVS	KV (BP3)	KVS
	1	50	50	50	50	50
	2	100	100	100	100	100
	3	170	170	170	170	170
	4	240	240	250	240	250
	5	310	330	350	330	350
	6	380	420	470	420	470
	7	470	540	660	540	660
	8	530	650	820	650	820
	9	610	820	1050	820	1050
	10	710	1000	1400	950	1200

Thermostatic Valves

PUSH PUSH PRESET KV VALVE

HYDRAULIC FEATURES - Kv at BP2

