

KAI, ITH og AKH

Roof hoods for intake and exhaust

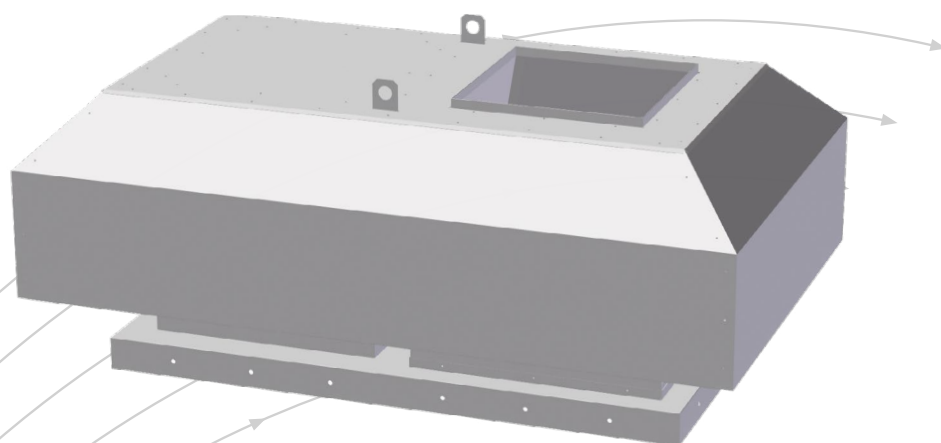

- Low-profile design
- Intake and exhaust in the same product (KAI)
- Connection duct as an added feature
- Now with a diagram to aid accurate sizing

TROX[®] TECHNIK

 **Auranor**

TROX Auranor AS

Auranorvegen 6
NO-2770 Jaren

Telephone +47 61 31 35 00

E-mail: office-no@troxgroup.com
www.trox.no/en

KAI, ITH and AKH

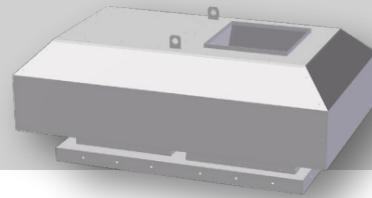

APPLICATION

KAI is a rectangular roof hood that contains both an intake section and an exhaust section.

ITH is a rectangular intake hood.

AKH is a rectangular exhaust hood.

DESIGN

KAI and ITH both have an aluminium insect net that prevents insects from entering the system, and a self-closing damper in the exhaust section. The internal drainage system inhibits water ingress. An insulated connection duct can be supplied as an added feature, which has an impermeable bottom plate that allows to connect any duct size. As a speciality product, KAI can be shipped with a double intake or exhaust hood. The foot plate and connection duct sizing can be customized upon request.

MATERIALS AND SURFACES

KAI, ITH og AKH are all manufactured in galvanised steel. The dampers in KAI and AKH are made out of aluminum. The products can be produced in other materials or be coated upon request. The connection ducts are produced in galvanised steel and insulated using mineral wool with glass fibre cloth. As Special materials, it can be supplied in copper, stainless steel, acid-resistant steel, or Magnelis.

QUICK SELECTION

Type	KAI and ITH (intake) [m³/h]		
	20Pa	30Pa	40Pa
B*	612	738	900
1	2880	3258	3960
2	4320	5040	5760
2b	7200	9000	10440
3	10800	13680	15120
4	16200	19800	23400

Table 1: Displays air flow rates in m³/h for intake

Type	KAI og AKH (exhaust) [m³/h]		
	50Pa	75Pa	100Pa
B*	504	576	702
1	1476	1836	2124
2	3420	4320	5040
2b	7200	9000	10440
3	10080	12240	14400
4	14760	18000	21600

Table 2: Displays air flow rates in m³/h for exhaust

ORDER CODE, KAI, ITH og AKH

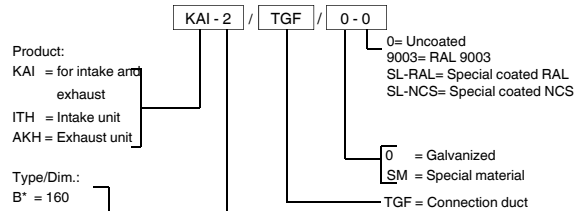

*Type B-Only KAI without TGF

Example:
KAI-2/ TGF/0-0

Explanation:
KAI combo-hat, type 2 for dimension Ø400 - Ø500, connection duct (TGF) is shipped unmounted, galvanised, uncoated

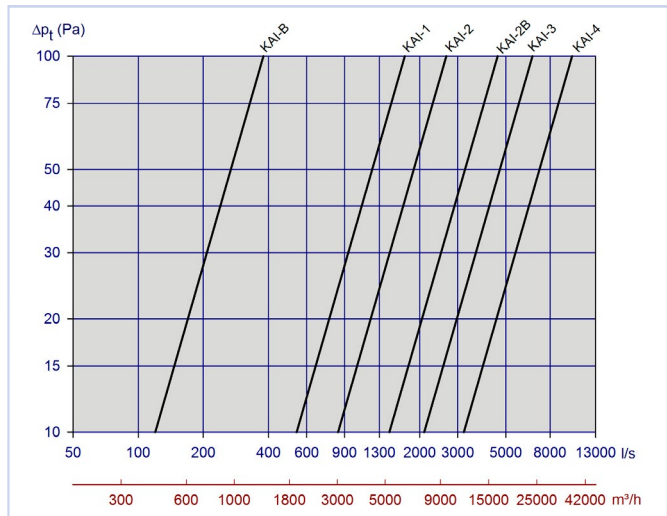

Diagram 1, intake

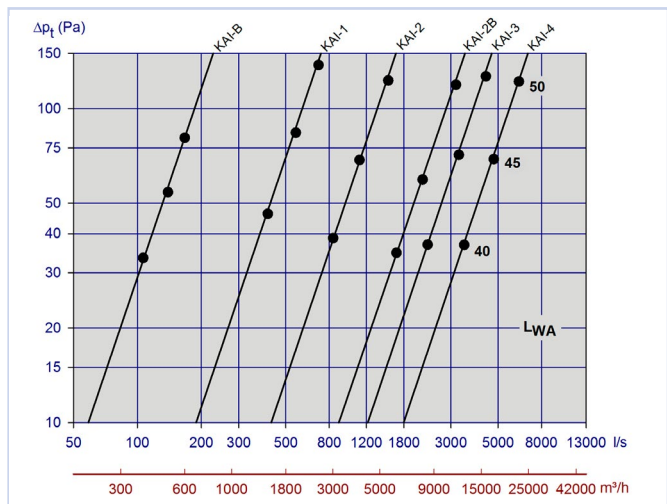
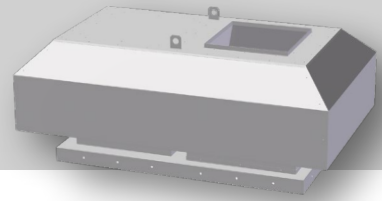

Diagram 2, exhaust

KAI, ITH and AKH



DIMENSIONS AND WEIGHTS - KAI, ITH AKH AND CONNECTION DUCT (TGF)

KAI, ITH og AKH												Weight [Kg]			
Type	Duct dim.	A	B	C	D	E	F	G	H	J	K	KAI	TGF for KAI	ITH/ AKH	TGF for ITH/ AKH
B	160	697	475	320	555	83	118	138	324	360	595	12	-	-	-
1	200-315	1078	646	428	852	88	145	261	340	597	1022	25	46	28	23
2	400-500	1552	934	612	1222	118	197	407	550	782	1392	55	66	47	34
2B	500-630	1995	1144	814	1622	193	226	520	715	912	1720	95	76	50	38
3	630-800	2322	1404	912	1822	248	287	664	880	1082	1992	139	98	92	50
4	1000	2834	1717	1120	2240	308	361	824	1100	1282	2392	175	124	138	64

Table 3

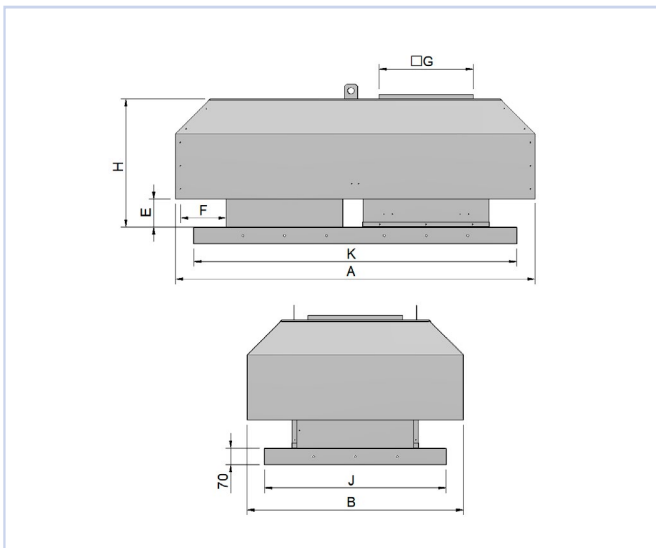

Figure 1, KAI

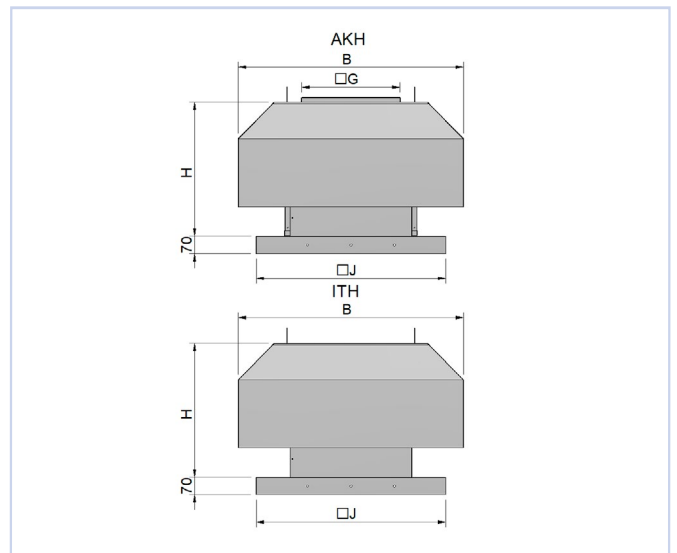

Figure 2, ITH and AKH

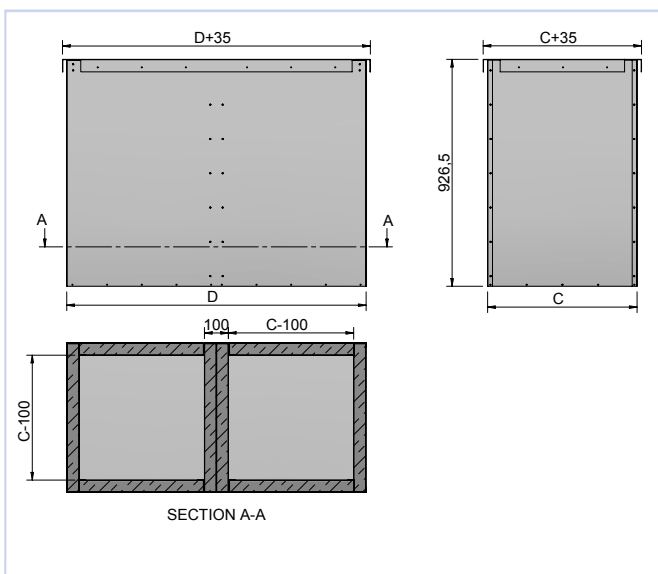

Figure 3, TGF for KAI

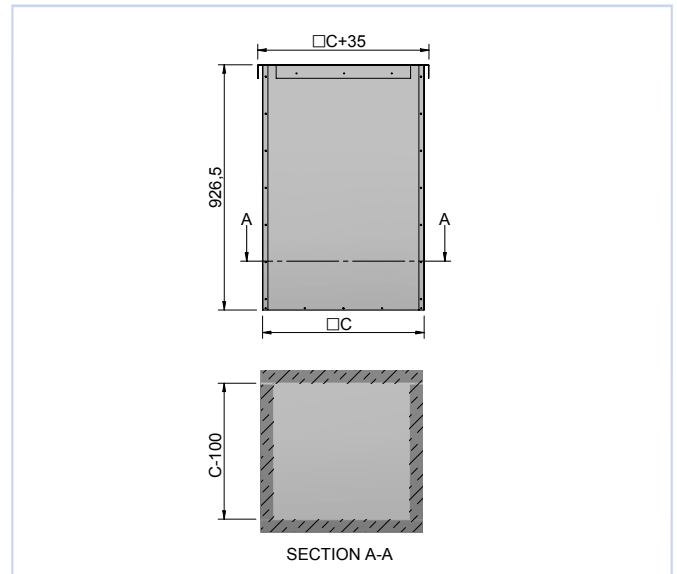
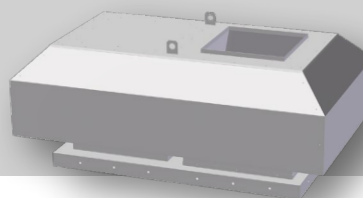

Figure 4, TGF for ITH and AKH



THROW LENGTH

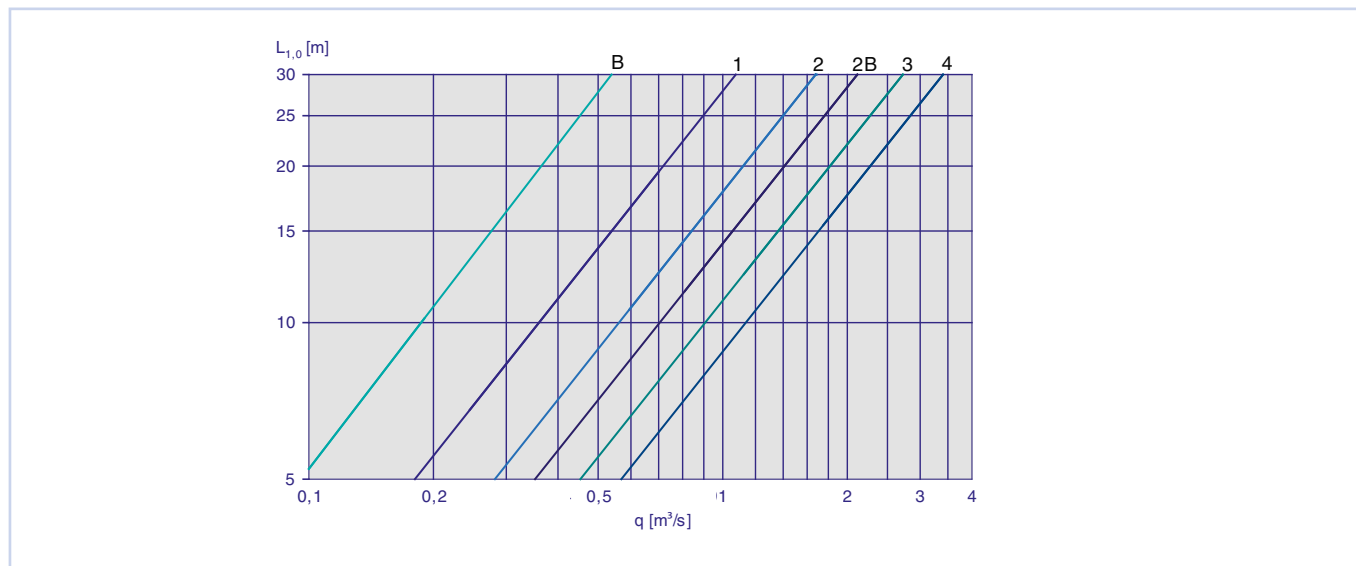

Diagram 3: Displays isothermic throw lengths to 1 m/s.

INSTALLATION

Mounting instructions are displayed in figure 5 and 6. The roof unit and the connection duct are mounted together with the supplied screws.

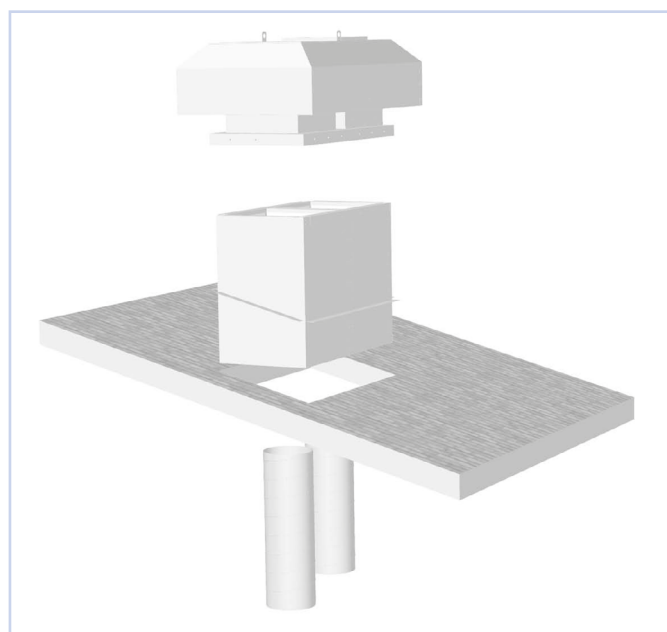

Figure 5: Installation

ENVIRONMENT

Enquiries regarding product declaration can be directed to our sales team, or information can be found on our website: www.trox.no

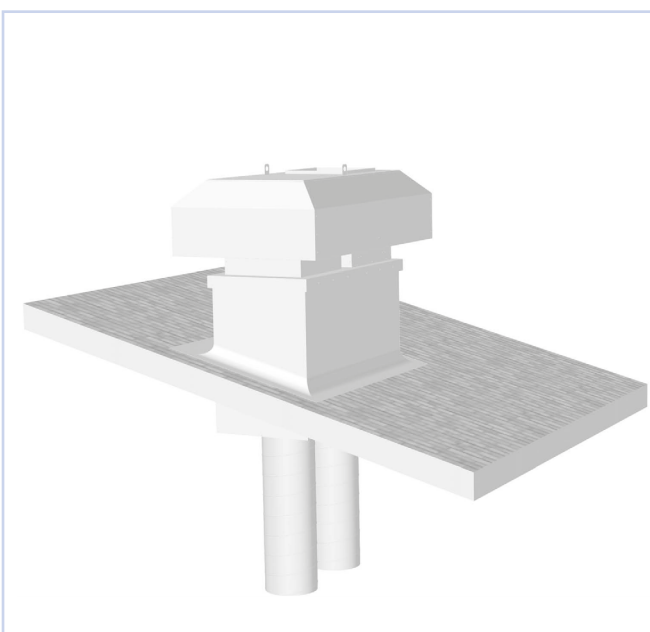

Figure 6: Installation

KAI, ITH and AKH are developed and manufactured by:
TROX Auranor Norge AS

The company reserves the right to make amendments
without prior notice.