

Installation Svalbard H

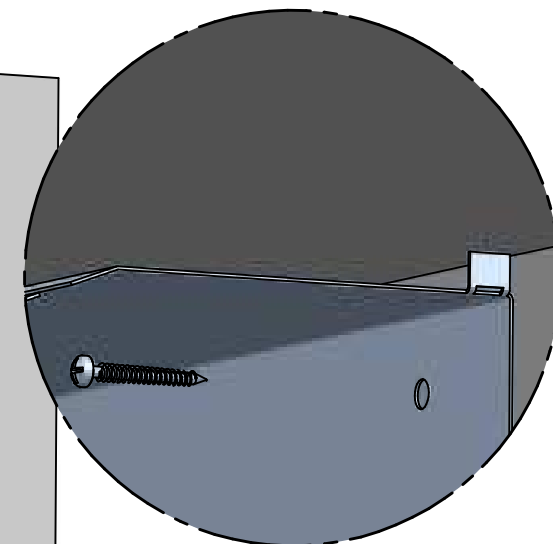

DETAIL A

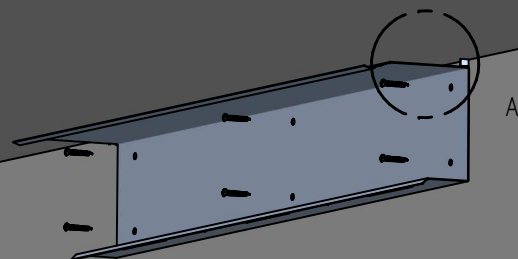
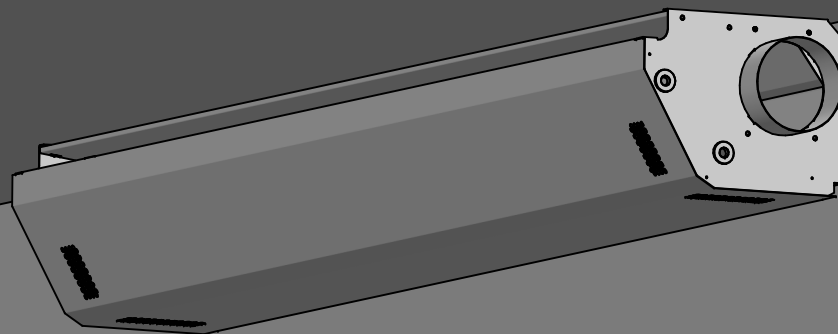

Bend the tabs on the mounting bar upwards.

Place the top of the tabs against the ceiling.

The mounting bar comes centrally on the beam, with the possibility of adjustment of $\pm 50\text{mm}$.

Fit the mounting bar on to the wall, like the sketch.

Then place the beam on to the mounting bar.

The unit is positioned correctly when you hear a click, both above and below.

The beam can now be adjusted lengthways.

Fold down the front panel and control that the tabs is firmly placed in the slots.

Lock the beam by using a screw through the hole on the mounting bar and in to the beam.

Place the front panel back to its original position.